

**Minimum roof pitch 5°**

Seamlap®  
sheets on  
breather  
membrane

500mm pan width or 305mm pan width (dependent  
on site location)

25mm

s/steel  
screws

Ply/Timber/OSB deck & rafters by  
Others in accordance with relevant  
standards. Min thickness recommended  
18mm Ply, 15mm OSB 3.

Ventilated  
Void minimum  
50mm

## Section

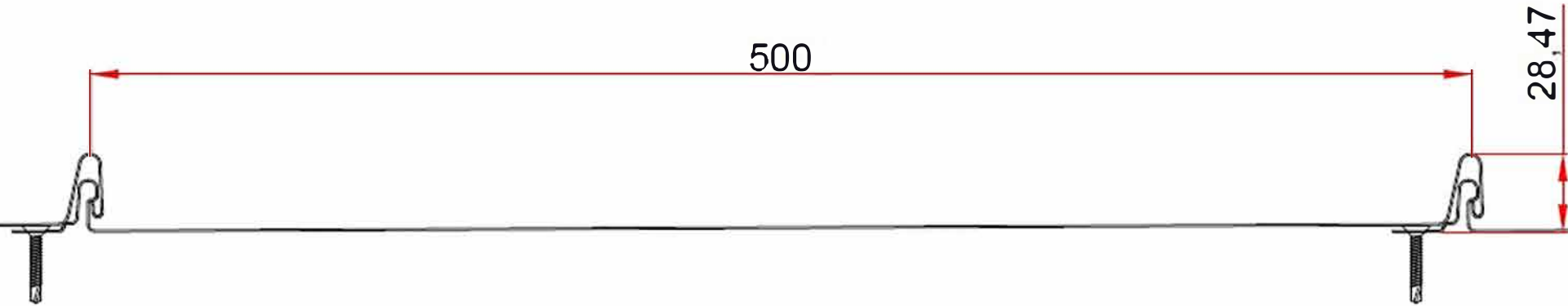

## Plan

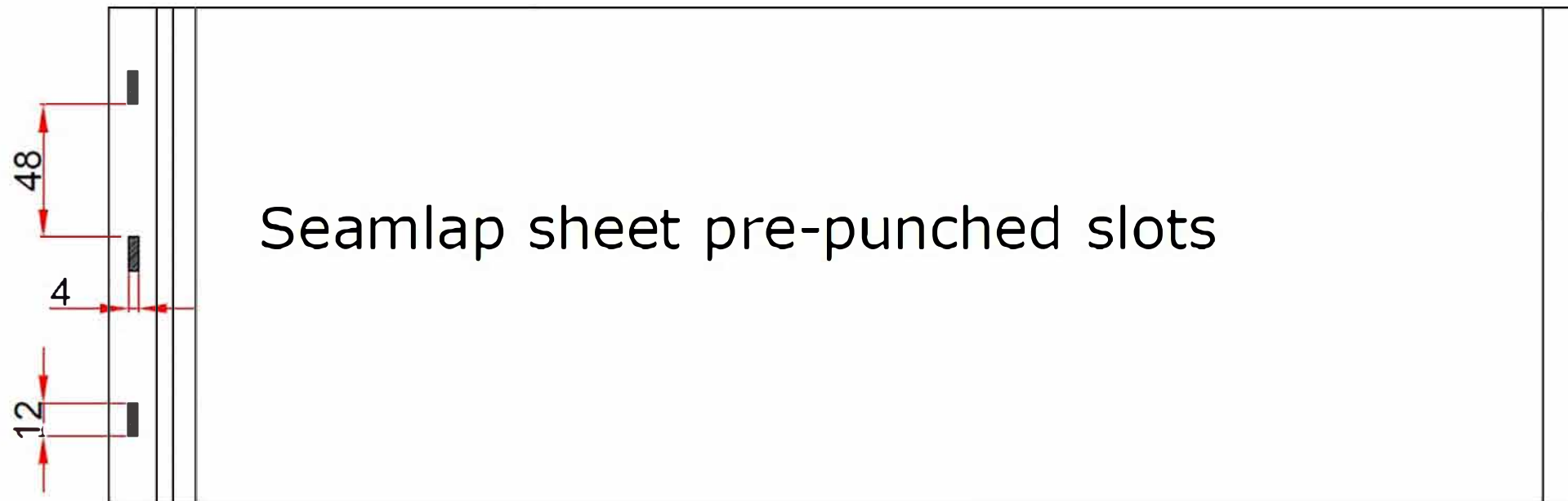

**Minimum roof pitch 5°**

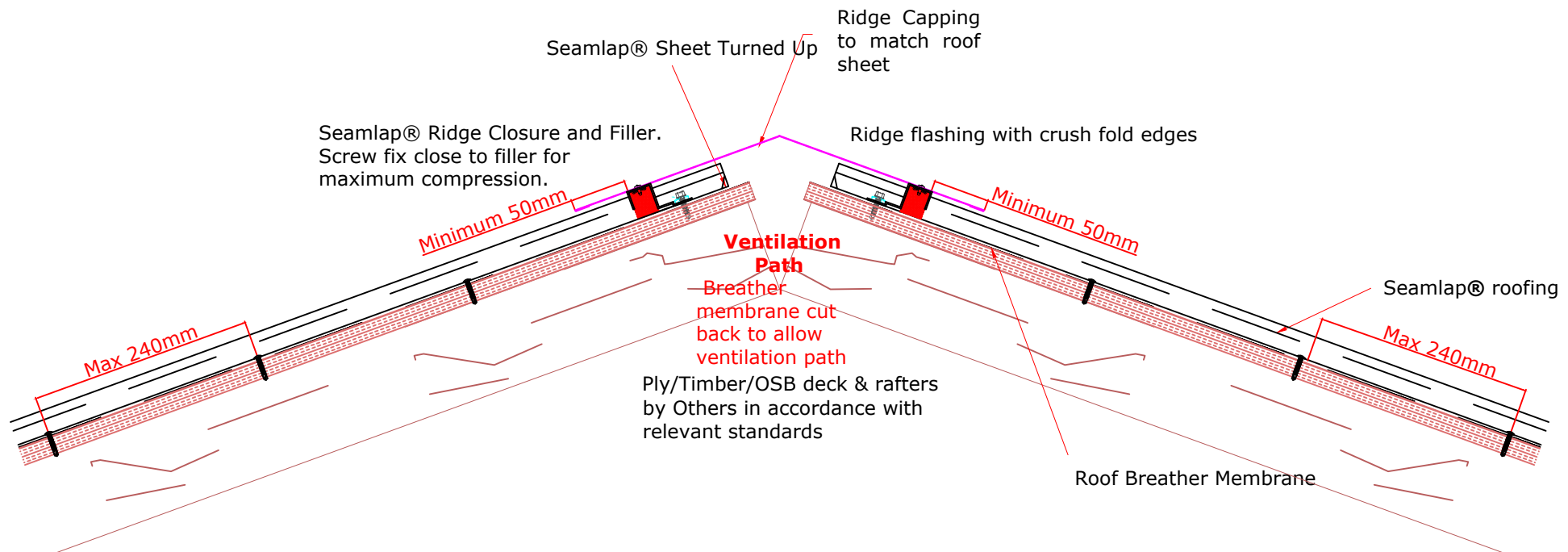

**Minimum roof pitch 5°**

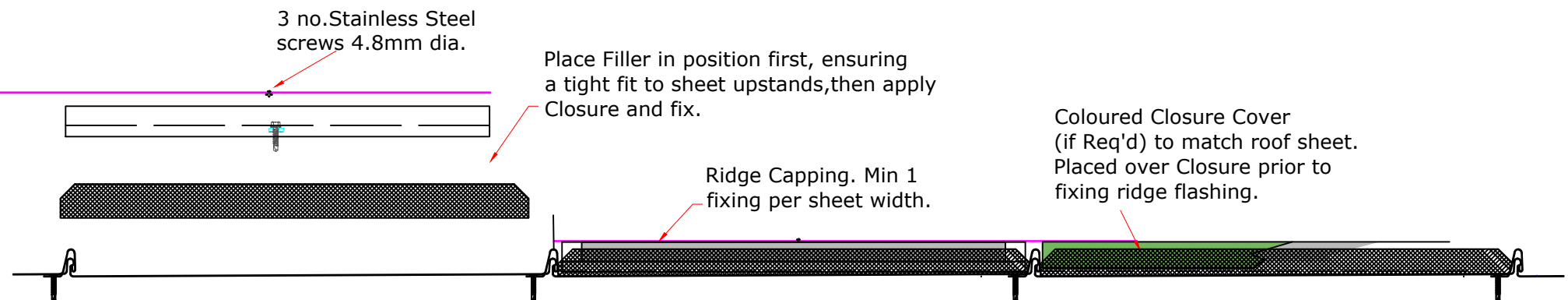

## Ventilated Ridge Zed Clip

**Minimum roof pitch 5°**

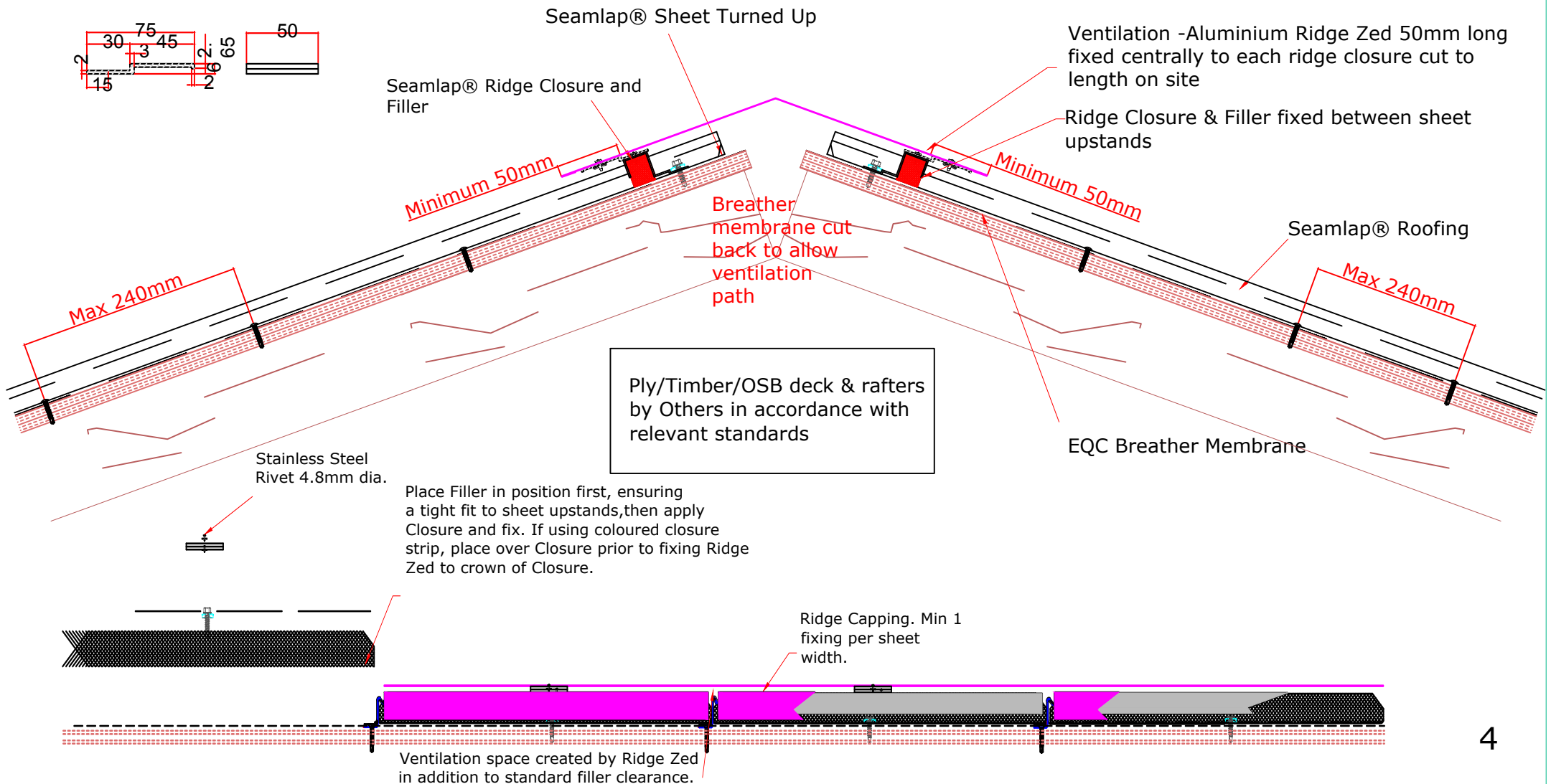

## Minimum Roof Pitch 5°

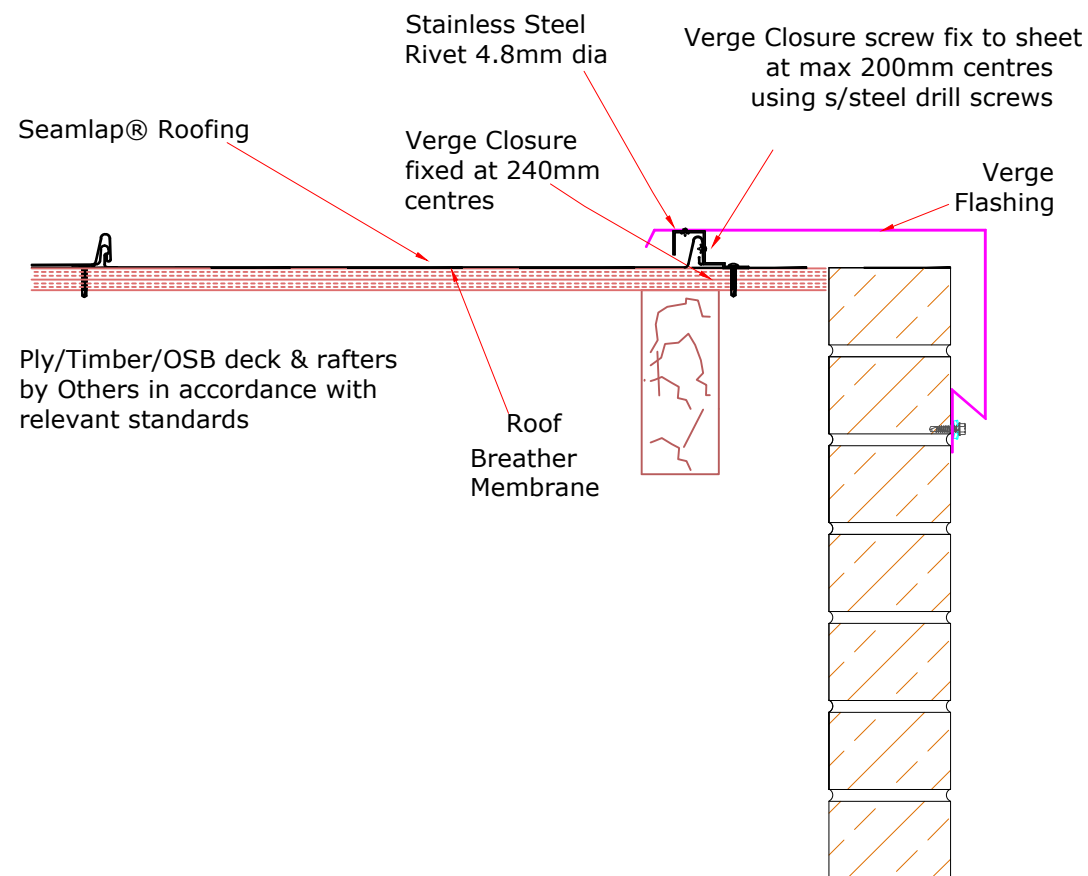
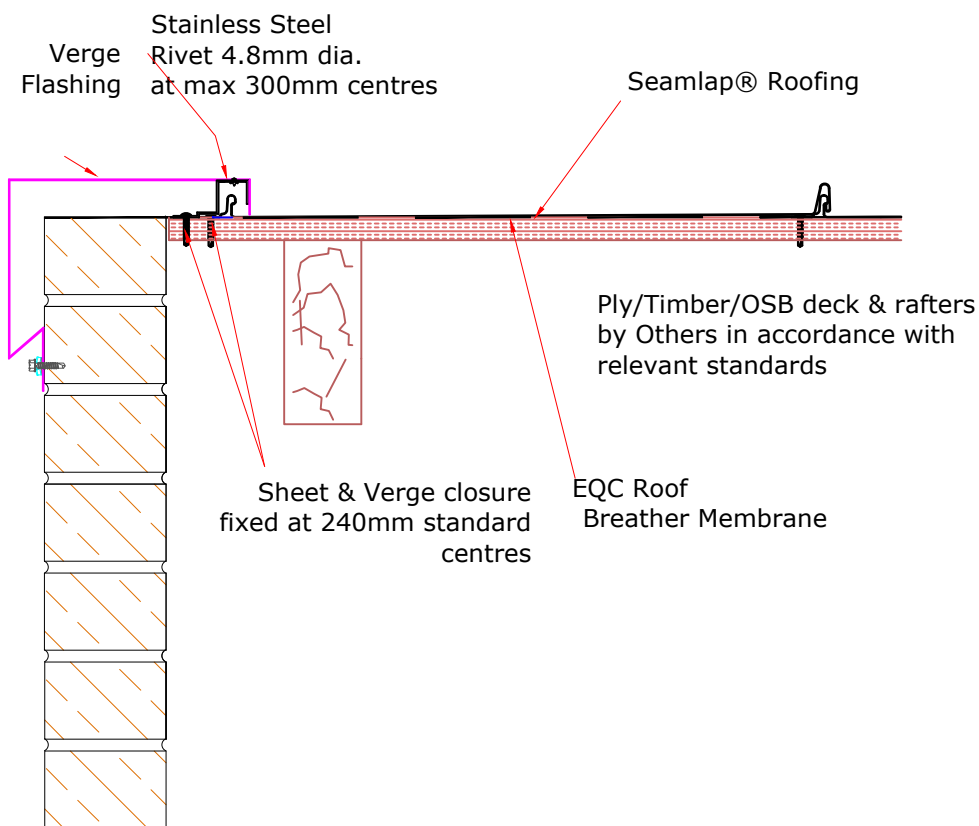

TITLE: **SEAMLAP® STANDING SEAM**

DWG NO: VE1\_CR\_TD

DWG REF: **Seamlap® Eaves Detail**

ISSUE DATE: April 2019

(To be read in conjunction  
with Seamlap® system  
specification documents)

EQC Ltd.,  
Tel. (+353) 045 981100  
E: [info@eqc.ie](mailto:info@eqc.ie)  
W: [www.eqc.ie](http://www.eqc.ie)

This draft drawing has been supplied by EQC Ltd for the purpose of guidance free of charge. It is a suggested typical detail and as such should not be assumed suitable for any specific project or application. No responsibility is assumed for errors or misinterpretations resulting from the information contained in the drawing. Details are for illustration only and no liability is accepted. We reserve the right to change the details without notice. The drawing is copyright, it remains our property.

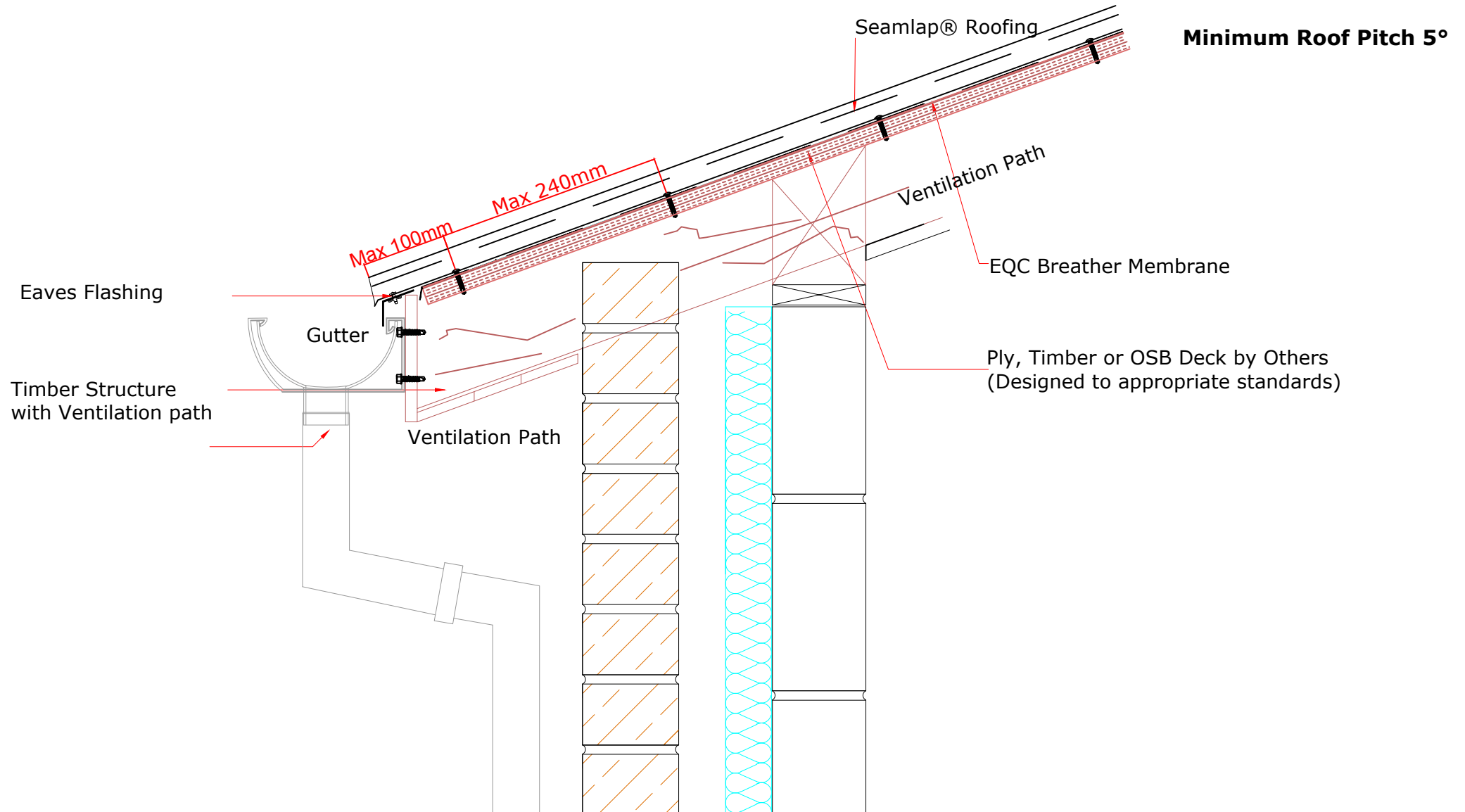

**Minimum Roof Pitch 15°**

